







**How to Replace the Control Module and FV Sensor  
Flash Code 2-1 and 2-3 only**

**You must unplug the water heater to perform this procedure. If not, you will trip the sensors in the control pod immediately upon installation. That will cause the unit to fault into a flash code of 2-3. New parts will be required.**

<p>1. Turn the unit off. <b>Unplug the heater.</b> If not, you will damage the replacement components and could be shocked with 120 volts of electricity.</p>	
<p>2. Turn the gas valve to OFF Remove plastic grey cover to the Molex connections</p>	
<p>3. Disconnect all wiring and Molex connectors from the gas valve.</p>	
<p>4. Using a TORX 15 tamper resistant screwdriver, remove the single screw on the grey control module housing. Keep the screw.</p>	
<p>5. Using a flat tip screwdriver, gently pry the retaining tabs holding the control module in place. There are four tabs; One on top; one on bottom; and two on the left side of the valve</p>	



**How to Replace the Control Module and FV Sensor  
Flash Code 2-1 and 2-3 only**

6. Remove and save the old plastic grey module.

Place new electronic module in position and press firmly to engage locking tabs.



7. Replace TORX 15 screw.



8. Find the Flammable Vapor (FV) Sensor Molex connector and wire

9. Unthread wires from retainer clips on main burner supply tube.

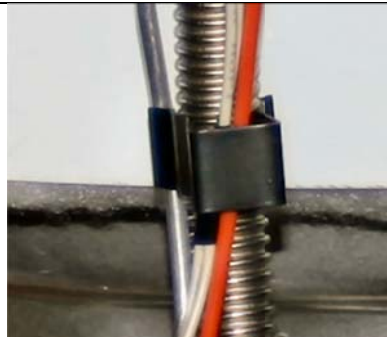

10. Gently grab and pull the sensor from the mounting hole. Unthread the remainder of the wiring harness.

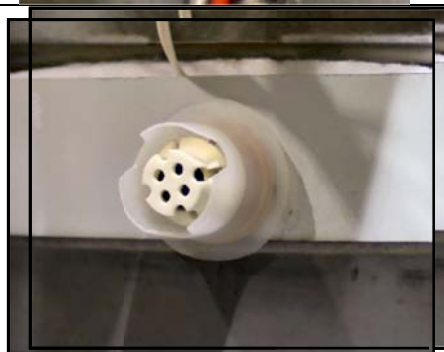

11. Replace in reverse order.



**How to Replace the Control Module and FV Sensor  
Flash Code 2-1 and 2-3 only**

12. Rethread wires thru retainer clips on burner supply tube and reconnect Molex connect to control valve.

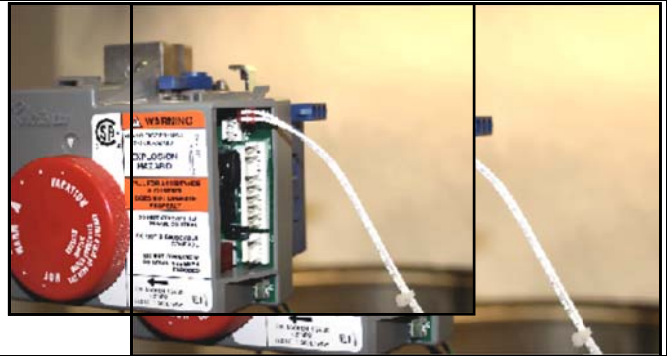

13. Reconnect all other Molex connectors in accordance with connection diagrams.



14. Set temperature selector to Vacation. Plug water heater back into electrical source. **Plug water heater back in.** Turn gas valve to ON. Turn water heater on at blower motor.



15. Cycle the PowerVent and inspect for main burner. Set red temperature dial on thermostat to a safe position not to exceed 120 degrees



Return both the sensor and the control pod in the shipping box used for the repair parts. Write the serial number to the water heater on the outside of the box and ship them back to Rheem at:

Rheem Return Parts  
2773 Gunter Park Drive West  
Montgomery, AL 36109