



SUBMITTAL COVER SHEET

PROJECT NAME _____						
LOCATION _____						
ARCHITECT _____						
ENGINEER _____						
CONTRACTOR _____						
SUBMITTED BY _____ DATE _____						
UNIT SUMMARY						
Quantity						
Unit Designation						
Model No.						
Total Cooling						
Sensible Cooling						
Air Ent. Evaporator						
Air Lvg. Evaporator						
Heating Input						
Heating Output						
CFM/ESP						
EER/SEER						
Electrical						
Minimum Ampacity						
Min.-Max. Breaker						
Net Unit Weight						
Accessory						
Catalog Form Number						
ACCESSORIES:				NOTES:		

SUBMITTAL SHEET FOR RSPM- 14 SEER 2 TO 5 NOMINAL TON [7.0 TO 17.6 kW] FEATURING INDUSTRY STANDARD R-410 REFRIGERANT PACKAGE AIR CONDITIONERS



JOB NAME _____ LOCATION _____

CONTRACTOR _____ ORDER NO. _____

ENGINEER _____ UNIT MODEL NO. _____

SUBMITTED FOR ☐ APPROVAL ☐ RECORD COIL MODEL NO. _____

DATE _____ AIR HANDLER MODEL NO. _____

UNIT DATA

COOLING PERFORMANCE

TOTAL CAPACITY* MBH

SENSIBLE CAPACITY* MBH

OUTDOOR DESIGN TEMP. °F [°C] DB/WB

TOTAL SUPPLY AIR CFM [L/s]

TEMP. OF AIR ENTERING
EVAPORATOR COIL °F [°C] DB/WB

POWER INPUT REQUIREMENT KW

SEER RATING
(*uses blower motor heat)

SUPPLY AIR BLOWER PERFORMANCE

TOTAL SUPPLY AIR CFM [L/s]

TOTAL RESISTANCE EXTERNAL
TO UNIT IWG

BLOWER SPEED RPM

POWER OUTPUT REQUIREMENT BHP

MOTOR RATING HP [W]

POWER INPUT REQUIREMENT KW

ELECTRICAL DATA

POWER SUPPLY HZ

TOTAL UNIT AMPACITY AMPS

MINIMUM WIRE SIZE AWG

MAXIMUM OVERCURRENT DEVICE
FUSES HACR BREAKER AMPS

TOTAL UNIT WEIGHT

TOTAL OPERATING WEIGHT LBS [kg]
(including field-installed accessories)

CLEARANCES

SIDE "A"	18" [457 mm]
SIDE "B"	0"
SIDE "C"	12" [305 mm]
SIDE "D"	30" [762 mm]
ABOVE UNIT	60" [1524 mm]

FEATURES FOR RSPM-

- Scroll Compressor
- Copper Tube/Aluminum Fin Coils
- Powder painted louvered steel cabinet protects coil from yard hazard damage
- Painted Base Pan
- Easily accessible Gauge Ports
- Spacious control box for easy accessibility
- Power and control wiring are separated
- Certified and rated under ARI Standard 240
- U.L. listed
- Zero Clearance to structure
- Hi-Static Capability
- Indoor Coil access for easy cleaning
- Slide-Out Indoor Blower for easy motor & blower maintenance
- Slide-Out Drain Pan for easy access and cleaning
- Round Horizontal Supply & Return for application adaptability
- Duct Collars provided
- Condensate Trap provided
- Removable Base Rails
- Factory run-tested prior to shipment
- Electric Heat Factory or Field Installed
- Factory limited warranty on parts as follows:
Compressor Five (5) Years
Parts One (1) Year

[] Designates Metric Conversions



Dimensions

Model	Height "A"
024, 030, 036, 042, 043	29 1/8"
048, 060	37 1/8"

FRONT VIEW

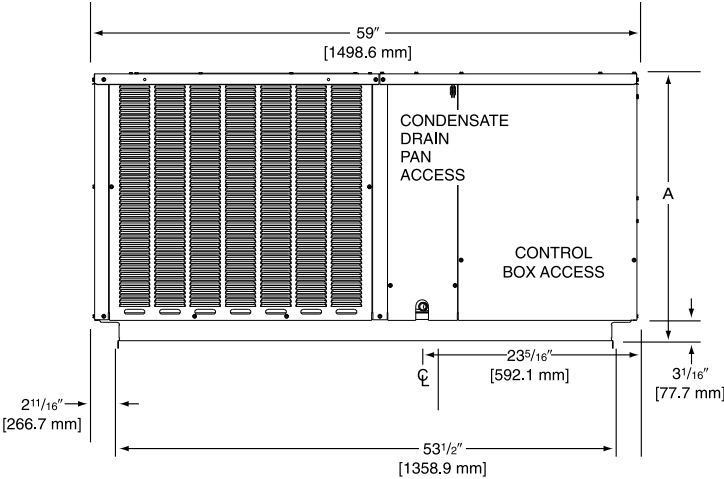

REAR VIEW

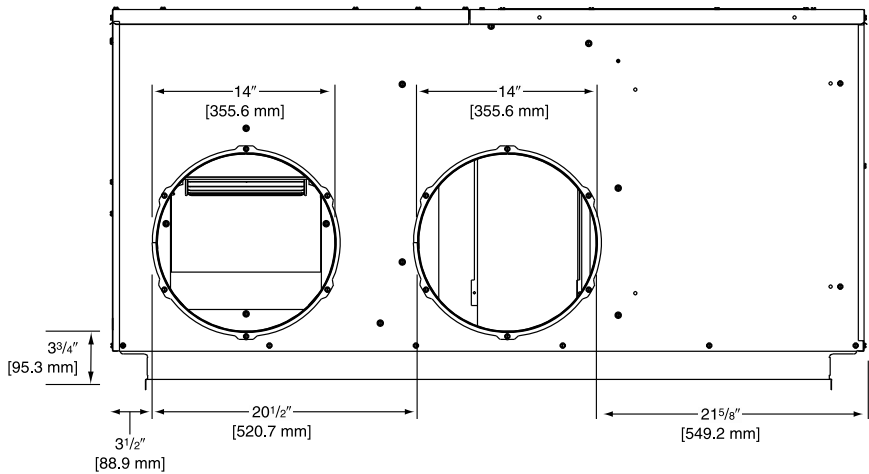

ELECTRICAL CONNECTIONS

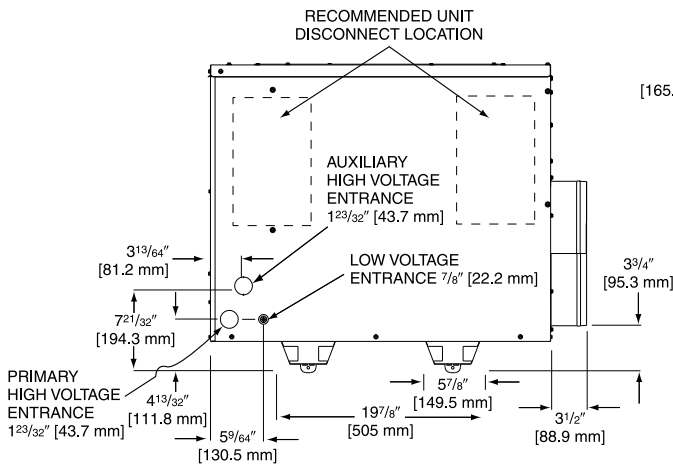

BOTTOM VIEW

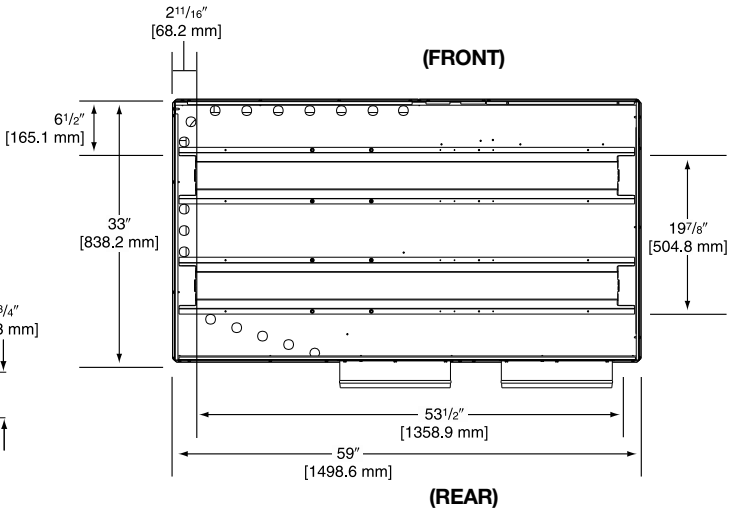

[] Designates Metric Conversions

Before proceeding with installation, refer to installation instructions packaged with each model, as well as complying with all Federal, State, Provincial, and Local codes, regulations, and practices.